

SUBMITTAL DATA SHEET

E-Series DuraMAC™ Booster Pumps
Residential | Light Commercial | Irrigation

E-Series DuraMAC™ - Residential Booster



See Pumps & Accessories
Price List for Limited
Warranty details.

Not all boosting applications require complicated boosting systems. The E-Series DuraMAC™ Boosting system is simple and reliable.

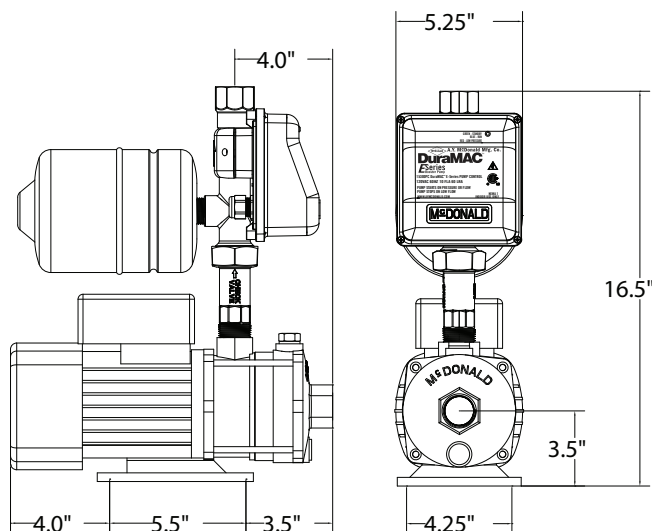

*See chart below

DuraMAC™ Performance (Additional Boost)

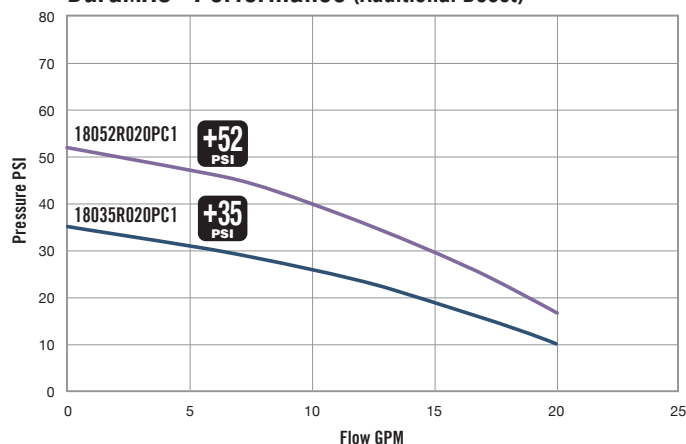

20 Gallon/Minute (GPM) Max

E-Series DuraMAC™ Model	Pump Boost	Amps	Length "L"	Voltage	Power	Pressure Reducing Valve recommended for installation with incoming pressure greater than:
18035R020PC1	35 PSI	5.5	13"	120 - 60 Hz	1/2 HP	45 PSI
18052R020PC1	52 PSI	7.0	13.7"	120 - 60 Hz	3/4 HP	28 PSI

Pressure tank required. See instruction manual for sizing information.

*Many plumbing codes do not recommend system pressure exceeding 80 PSI. Refer to local plumbing codes for maximum boosted pressure.

SUBMITTAL INFORMATION

- Water Pressure Boosting System for residential, irrigation or light commercial use
- Easy set-up installation
- Digital control
- Durable connections - no plastic connections
- Half gallon pressure tank included
- TEFC single phase motor for quiet operation
- Electronics separated and sealed from waterway
- Check valve included
- Dry-Run protection

NO-LEAD: The weighted average of the wetted surface of this no-lead product contacted by consumable water contains less than one quarter of one percent (0.25%) lead.



A.Y. McDonald Mfg. Co.
P.O. Box 508
Dubuque, IA 52004-0508

Toll Free: 1-800-292-2737
Fax: 1-800-832-9296
Hours: 7:00 a.m. - 5:00 p.m., CST

sales@aymcdonald.com
www.aymcdonald.com

A.Y. McDonald considers the information on this assembly drawing correct when published. Item and option availability, including specifications, are subject to change without notice.

Submitted by:

SUBMITTAL DATA SHEET

E-Series DuraMAC™ Booster Pumps
Residential | Light Commercial | Irrigation

E-Series DuraMAC™ - Residential Booster



See Pumps & Accessories
Price List for Limited
Warranty details.

Sizing Information

E-Series DuraMAC™ Booster Systems are designed to shut off when no flow is detected. Pump total pressure boost should be added to current household system pressure to determine total system pressure when boosted. Note: It is not recommended to exceed 80 PSI total boosted household pressure.

Example:

Household system pressure before boost = 30 PSI

$$\begin{array}{ccccccc} \mathbf{30} & + & & = & & & \\ \text{Household} & & \text{Total Pump} & & \text{Total Pressure} & & \\ \text{Pressure} & & \text{Pressure} & & \text{After Boost} & & \end{array}$$

*Not Recommended to Exceed 80 PSI

Models Available: Boost

18035R020PC1

18052R020PC1

$$\begin{array}{ccccccc} \mathbf{30} & + & \mathbf{35} & = & \mathbf{65} & & \\ \text{Household} & & \text{Total Pump} & & \text{Total Pressure} & & \\ \text{Pressure} & & \text{Pressure} & & \text{After Boost} & & \end{array}$$

+35
+52

Based on this example, the recommended model for this application is the 18035R020PC1.

For systems with fluctuating pressure, a pressure reducing valve is recommended to assure system pressure stays below 80 PSI.

Sizing Chart

Total static pressure DuraMAC™ pump		
Incoming Pressure (PSI)	18035R020PC1 +35	18052R020PC1 +52
60		
55	90	
50	85	
45	80	
40	75	
35	70	87
30	65	82
25	60	77
20	55	72
15	50	67
10	45	62

CONTACT FACTORY

Typical Installation

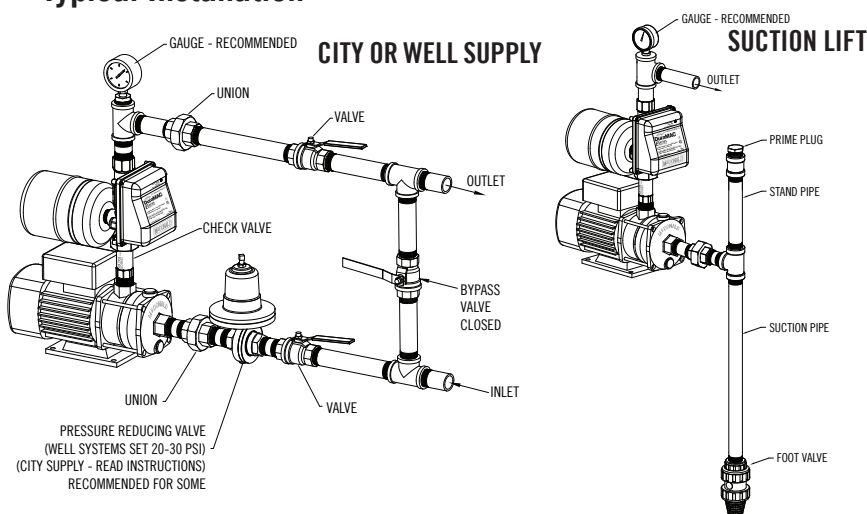

Materials of Construction

Impellers	304 Stainless Steel
Pump Casing Inlet	301 Stainless Steel
Pump Casing Outlet	301 Stainless Steel
Pump Seal (stationary)	Silicon Carbide
Pump Seal (rotating)	Carbon
Diffuser	304 Stainless Steel
Check Valve	No-Lead Brass
Pump Controller	No-Lead Brass

NO-LEAD: The weighted average of the wetted surface of this no-lead product contacted by consumable water contains less than one quarter of one percent (0.25%) lead.



A.Y. McDonald Mfg. Co.
P.O. Box 508
Dubuque, IA 52004-0508

Toll Free: 1-800-292-2737
Fax: 1-800-832-9296
Hours: 7:00 a.m. - 5:00 p.m., CST

sales@aymcdonald.com
www.aymcdonald.com

A.Y. McDonald considers the information on this assembly drawing correct when published. Item and option availability, including specifications, are subject to change without notice.

Submitted by: